

YACHT
NEXT AVAILABLE DELIVERY

SANLORENZO

SL

96/A

SL
96/A



SL
96/A



SL
96/A



SL
96/A





05. Flying bridge



06. Flying bridge



07. Flying bridge







10. Salon



11. Owner's cabin



12. Owner's cabin



13. Owner's cabin



14. Vip cabin



15. Vip cabin



16. Vip bathroom



17. Vip bathroom

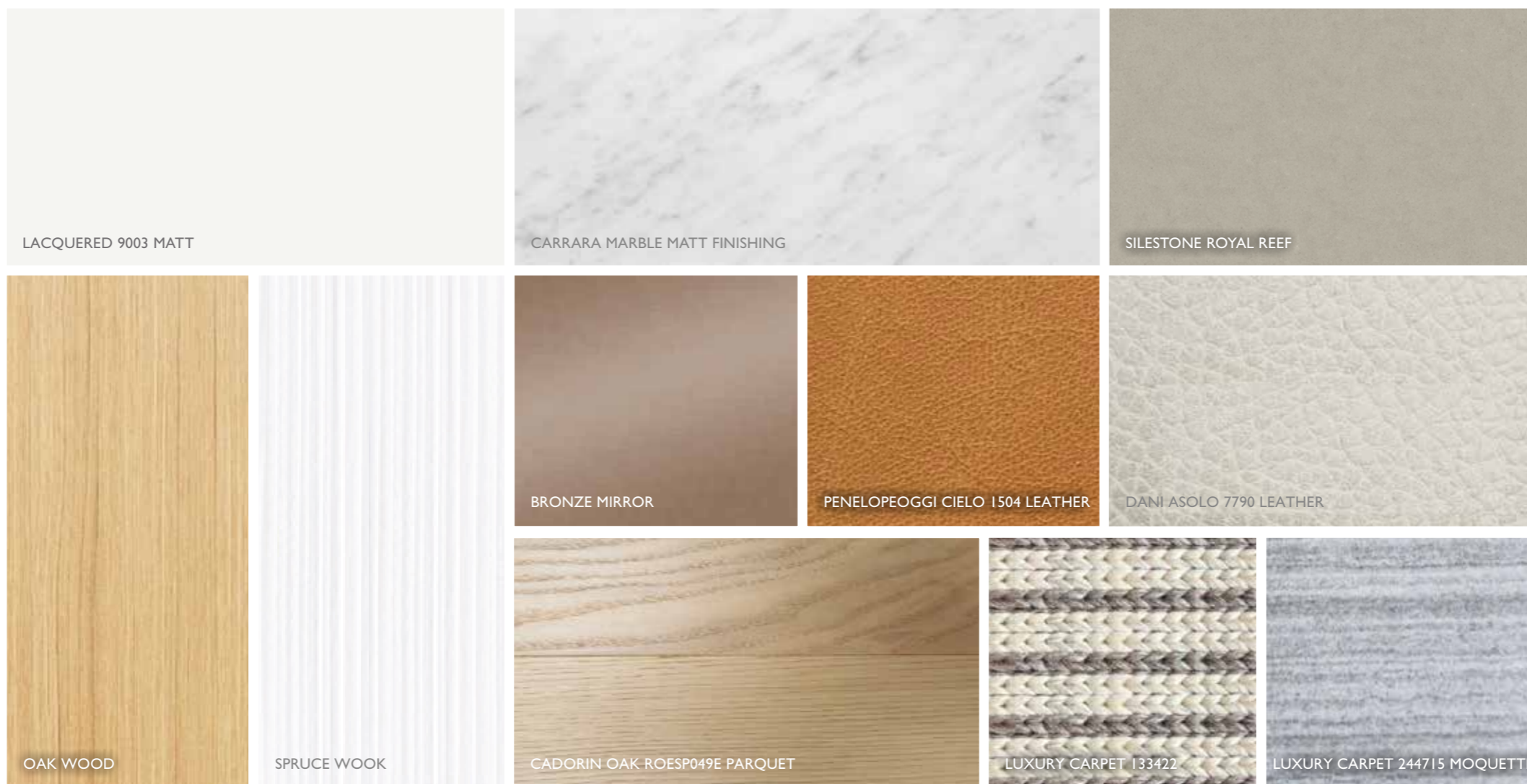



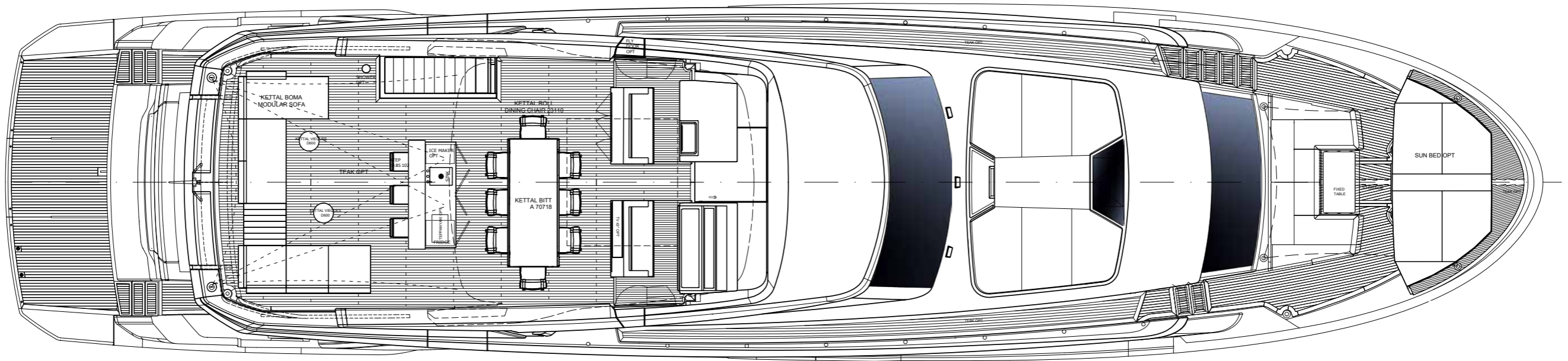

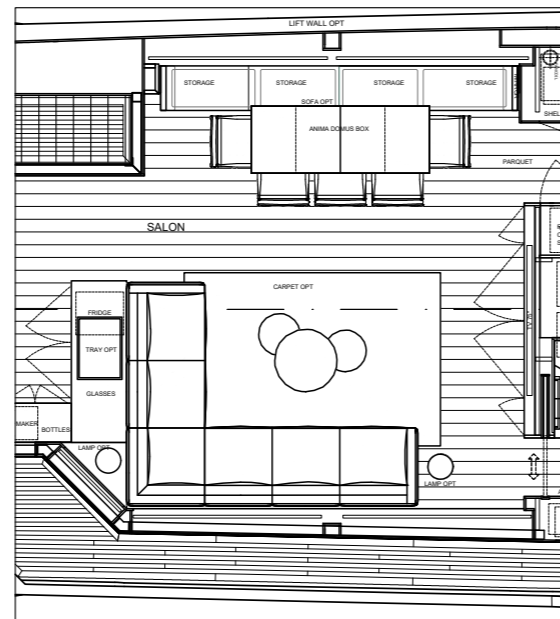
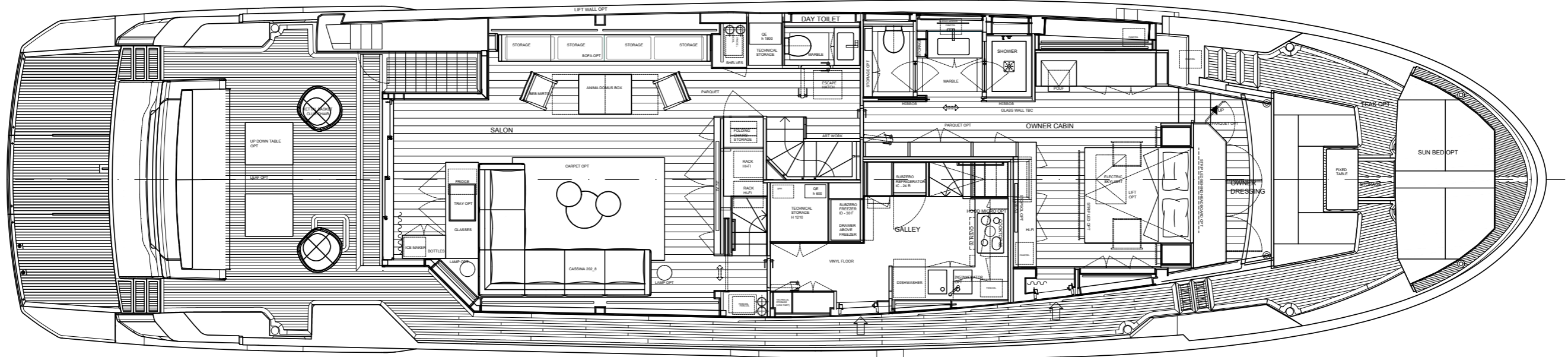

Alternative salon

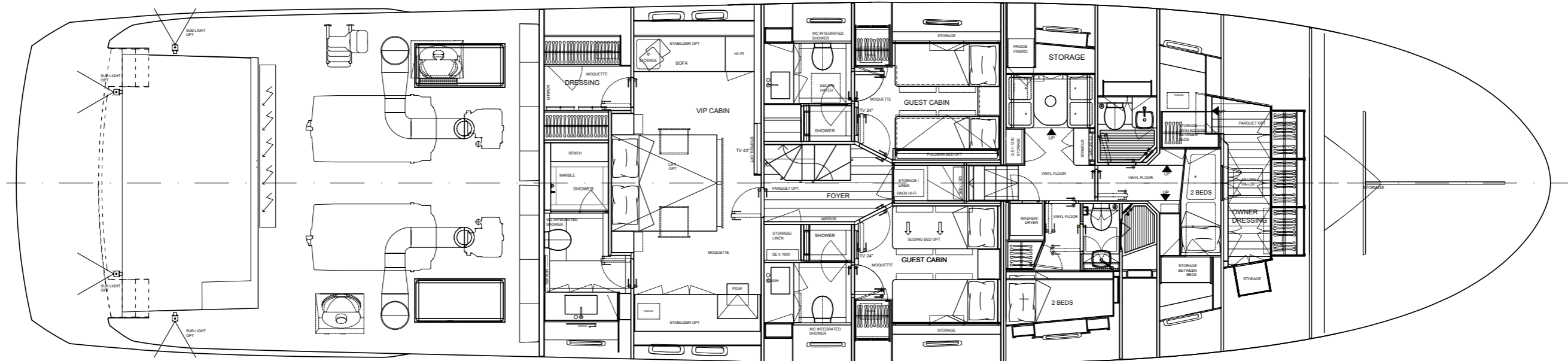

Length overall	29,06 m - 95' 4"
Maximum beam	6,76 m - 22' 2"
Construction height	3,25 m - 10' 8"
Displacement @ half load *	100 t - 220500 lb
Displacement @ full load *	110 t - 242500 lb
Waterline length @ half load	23,12 m - 75' 10"
Waterline length @ full load	23,18 m - 76' 00"
Draught @ half load	1,92 m - 6' 3"
Draught @ full load	1,98 m - 6' 6"
Guest accommodation	8 people
Crew accommodation	4 people
Engine	2 x MTU 16V2000M86 (2216 HP)
Consumption (approx) **	2 x 360 l/h - 95 gal @ 2200 rpm
Power output @ 100% MCR	2 x 1630kW @2450rpm
Gearbox	ZF3060V, R=3:1
Transmission	V-drive
Propeller	In Nibral in class "S"
Shafts	In Aquamet 17 or equivalent
Gensets	1 x 35 kW + 1 x 45 kW
Rudders	AISI316 Stainless Steel
Maximum speed (approx) ***	28 kn
Cruising speed (approx.) ***	24 kn
Economical speed (approx)	10 kn
Max range @ economical speed (approx)	1250 nm
Deadrise	16°
A/C power	188000 btu/h
Fuel capacity	10350 l - 2730 gal
Fresh water capacity	1500 l - 396 gal
Black water capacity	560 l - 147 gal
Grey water capacity	760 l - 200 gal
Tender length	max 4,5 m - 14' 9"
Tender weight	max 700 kg - 1540 lb

* Displacement data refers to a yacht with standard layout as described in the sales specification
 ** Main engine performance data and characteristics are derived from the manufacturer's specification
 *** Speed data refer to a yacht with standard layout as described in the sales specification, considering a third of liquid weight, a third of luggage weight (25kg per bed) and 5 crew members (80kg each), and without stabilization system and hard-top.

This brochure shall not be regarded as a contractual offer regarding the sale of yachts from the shipyard to individuals or companies. All the information contained in this brochure, including without limitation any technical or performance data, pictures, and drawings, are mere indications with no contractual value.

This document is based on the information available at the time it is published. In spite of the commitment aimed at guaranteeing maximum possible accuracy, the information contained herein may not cover all the details and any technical-commercial modifications introduced after printing, or may describe features that are not present.